

Composite Deck (Galvanized) G90

CD36 / CD36 CL

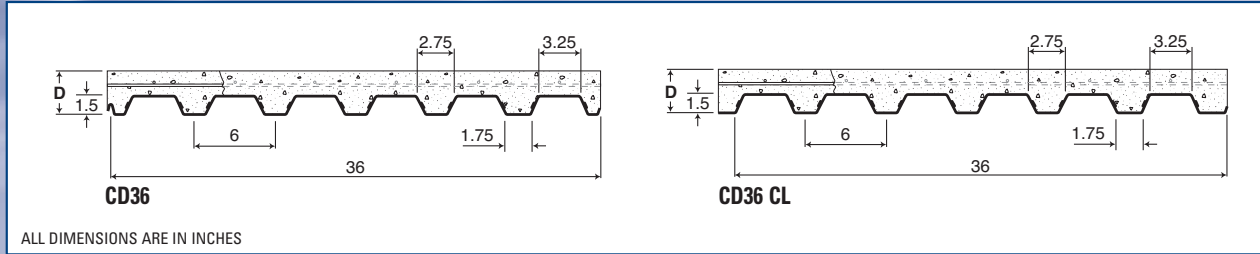

**Steel Deck Section Properties**  
(Per Foot of Width)

**Composite Slab Properties**  
(Per Foot of Width)

Base Steel Thickness (in.)	Weight Galvanized (psf)	Area of Steel (in <sup>2</sup> )	Yield Stress (KSI)	Section Modulus (in <sup>3</sup> )		Deflection Inertia Midspan (in <sup>4</sup> )	Overall Slab Depth, D (in.)									
				Midspan	Support		4.0	4.5	5.0	5.5	6.0					
0.030	1.66	0.474	33	0.184	0.194	0.163	Slab Weight (psf)									
0.036	1.99	0.569	33	0.226	0.233	0.207	Concrete Volume (yd <sup>3</sup> /100ft <sup>2</sup> )									
0.048	2.66	0.756	33	0.307	0.315	0.280	41.2	47.4	53.7	59.9	66.2	0.95	1.11	1.26	1.42	1.57

**Load Table**

Live Load Factor = 1.5; Importance Factor (I<sub>S-SLS</sub>) = 0.90; Importance Factor (I<sub>S-ULS</sub>) = 1.0

**Maximum Specified Uniformly Distributed Loads (psf)**

Slab Depth, D (in.)		4.0			4.5			5.0			5.5			6.0			
Base Steel (in.)	Span (ft.)	Deck Span			Deck Span			Deck Span			Deck Span			Deck Span			
		1	2	3	1	2	3	1	2	3	1	2	3	1	2	3	
0.030	5'-0"	400	400	400	400	400	400	400	400	400	400	400	400	400	400	400	400
	5'-6"	341	341	341	395	395	395	400	400	400	400	400	400	400	400	400	400
	6'-0"	288	288	288	334	334	334	381	381	381	400	400	400	400	400	400	400
	6'-6"	247	247	247	287	287	287	326	326	326	366	366	366	400	400	400	400
	7'-0"	215	215	215	249	249	249	283	283	283	318	318	318	352	352	352	352
	7'-6"	188	188	188	218	218	218	249	249	249	279	279	279	309	309	309	309
	8'-0"	166	166	166	193	193	193	220	220	220	247	247	247	273	273	273	273
0.036	5'-0"	400	400	400	400	400	400	400	400	400	400	400	400	400	400	400	400
	5'-6"	400	400	400	400	400	400	400	400	400	400	400	400	400	400	400	400
	6'-0"	356	356	356	400	400	400	400	400	400	400	400	400	400	400	400	400
	6'-6"	312	312	312	362	362	362	400	400	400	400	400	400	400	400	400	400
	7'-0"	276	276	276	321	321	321	365	365	365	400	400	400	400	400	400	400
	7'-6"	247	247	247	287	287	287	327	327	327	366	366	366	400	400	400	400
	8'-0"	223	223	223	259	259	259	295	295	295	330	330	330	366	366	366	366
0.048	5'-6"	400	400	400	400	400	400	400	400	400	400	400	400	400	400	400	400
	6'-0"	400	400	400	400	400	400	400	400	400	400	400	400	400	400	400	400
	6'-6"	400	400	400	400	400	400	400	400	400	400	400	400	400	400	400	400
	7'-0"	380	380	380	400	400	400	400	400	400	400	400	400	400	400	400	400
	7'-6"	347	347	347	400	400	400	400	400	400	400	400	400	400	400	400	400
	8'-0"	318	318	318	369	369	369	400	400	400	400	400	400	400	400	400	400
	8'-6"	294	294	294	341	341	341	389	389	389	400	400	400	400	400	400	400
	9'-0"	273	273	273	317	317	317	361	361	361	400	400	400	400	400	400	400
	9'-6"	243	243	243	294	294	294	337	337	337	378	378	378	400	400	400	400
	10'-0"	212	212	212	262	262	262	307	307	307	353	353	353	392	392	392	392

- Note: 1 - One shore support required at midspan in shaded areas.
- 2 - Slab Weight includes steel deck and concrete slab, which has been accounted for in load table.
- 3 - See Designer Notes - Composite Slab.
- 4 - See Designer Notes - Web Crippling for important notes regarding Web Crippling design.
- 5 - Bundled deck produced from either Galvalume or G90 Galvanized coated steel is susceptible to storage stain when exposed to the elements. This staining is superficial only and is not a valid reason for rejection of this product.